

## P4-2R(2.8-12) A AI

1T 2MP AI IR Fixed Dome Camera



### Features

- ▶ 1TOPS computing power
- ▶ Supports behavior analysis, crowd flow analysis, target detection, person detection, and object classification
- ▶ Supports backlight adaptation and overcast adaptation
- ▶ 1/2.7" CMOS sensor
- ▶ Software-defined architecture that supports loading and upgrade of algorithms
- ▶ 120 dB super wide dynamic range (WDR), ensuring that both foreground and background objects are clearly identified in environments with sharp light contrast

SuperCoding, reducing the bit rate by 50%

## Technical Specifications

Model		P4-2R(2.8-12)A AI				
Major Specifications						
Main control	Computing power	1 TOPS				
	Memory	DDR3 0.5 GB				
	Flash type	SPI NAND FLASH 512.0 MB				
Camera	Focal length	2.8-12mm				
	Max Aperture	F1.6(W)-F3.1(T)				
	Image sensor	1/2.7" CMOS/2MP 1920(H)*1080(V)				
	Lens aperture type	Fixed iris				
	Angle of view	Horizontal:32°(T) to 96°(W);Vertical:18°(T) to 53°(W)				
	IR range	30m				
	Zoom	Digital zoom:16x; Optical zoom: 4x				
	IR Wavelength	850 nm				
	DORI		D(m)	O(m)	R(m)	I(m)
		W	37.3	15.1	7.5	3.7
		T	160.0	64.5	32.0	16.0
Intelligence						
Target/Body	Target	Target detection/Target attribute recognition				
	Target recognition	Supported				
	Person	Person detection				
Other intelligences	Behavior analysis	Fast movement/Tripwire crossing/Intrusion/Area entry or exit /Loitering				
	Crowd flow analysis	Queue length/Head counting/Crowd flow statistics				
	Defocus	Supported				
	Basic Event	Motion detection/Abandoned object detection/Removed object detection				
	Alarm information	HTTPS certificate expiration/SDK certificate expiration/SDK root certificate expiration/SDK revocation certificate expiration/GB 35114 certificate expiration/802.1X certificate expiration/Log certificate expiration/Network disconnection/Network packet receiving anomaly /Full hard disk/Hard disk removal/Failure to write data to disks /Media stream interrupted/Log saving anomaly/Flash read/write /Temperature sensor fault/Hot swapping of network adapters/Video loss				
Open ecosystem						
Algorithm openness	Open OS	Supported				
Data openness	Data openness	SDK (proprietary protocol)/REST API (proprietary protocol)/GA/T 1400/GB/T 28181 (2011, 2016)/ONVIF Profile S/G/T/M				
Image						
Codec	Video encoding format	MJPEG/H.264/H.265				
	Video encoding channels	Triple streams				
	Intelligent encoding	Extra265/264/SuperCoding				
	Video frame rate	60/50/30/25fps				
Image AI	Scene adaptation	Backlight adaptation/Overcast adaptation				

Image ISP	Min illumination	Color: 0.002 lux (F1.6, AGC ON); B/W: 0.001 lux (F1.6, AGC ON) or 0 lux (infrared illuminator enabled)
	Day/Night mode	ICR Day/Night mode: automatic, color, B/W, and scheduled (default: automatic) Trigger mode: image triggered or internal signal triggered (default: image triggered)
	WDR	120dB
	White balance	Auto/Manual/OnePush
	HLC/BLC	Supported/Supported
	Shutter speed	Shutter speed range: 1/100000s to 1/25s Default value in live video mode: 1/25s Default value in target checkpoint mode: 1/25s Default value in micro checkpoint mode: 1/250s Default value in behavior analysis mode: 1/25s
	SNR	>45dB
	Primary stream resolution	1920×1080(1080P),1280×720(720P),720×576(PAL)
	Secondary stream resolution	Secondary stream 1:1920×1080(1080P),1280×720(720P),720×576 (PAL),720×480(NTSC); Secondary stream 2:720×576(PAL),720×480 (NTSC),352×288(PAL),352×240(NTSC)
	Video bit rate	1080p to 4K: 512 kbit/s to 16 Mbit/s 1080p: 256 kbit/s to 16 Mbit/s 720p: 256 kbit/s to 8 Mbit/s D1: 256 kbit/s to 4 Mbit/s CIF: 32 kbit/s to 1 Mbit/s
Digital noise reduction		2D/3D noise reduction
Audio		
Audio	Audio encoding format	G.711a/G.711u/G.726/OPUS/AAC
	Audio sampling rate	G.711a/G.711u/G.726:8K OPUS:8K/12K/16K/24K/48K AAC:8K/16K/22.05K/24K/32K/44.1K/48K
	Audio bit rate	G.711a/G.711u: 64 kbit/s; G.726: configurable (16/24/32/40 kbit/s); OPUS: configurable (16/24/32/40/64/96/128/160/192/224/256/288 kbit/s) AAC: 8 kHz sampling rate: 16/22/24/32/48 kbit/s 16 kHz sampling rate: 24/32/48/64/96 kbit/s 22.05/24/32 kHz sampling rate: 32/48/64/96/128 kbit/s 44.1/48 kHz sampling rate: 48/64/96/128/256 kbit/s
Networking		
Network transmission	Protocols supported by IPv4	TCP, IPv4, UDP, DHCP, DNS, CMP, IGMP, HTTP, HTTPS, FTP, SFTP, RTP, RTSP, RTCP, SIP, ARP, SSL, NTP, SNMP (V1/V2/V3), 802.1X, QoS, SMTP, and PPPoE Note: The northbound protocol should adapt to the PPPoE dialup scenario. Note: 802.1X supports authentication of only one RADIUS service.
	Protocols supported by IPv6	HTTP,HTTPS,RTP,RTCP,RTSP,Onvif,IPv6,ICMPv6,DHCPv6
Web Browser	Web Browser	32- or 64-bit Windows 7, Windows 8, or Windows 10 Google Chrome: 32-bit Google Chrome 38–49 (The IE Tab plug-in must be installed for Google Chrome 46–49.) 32- or 64-bit Google Chrome 50+ Internet Explorer: 32-bit Internet Explorer 10 and 11 Firefox: 32-bit Firefox 35–51 32- or 64-bit Firefox 70+ Microsoft Edge: 32- or 64-bit Microsoft Edge 50+ Restrictions: Compatibility problems may occur on the Firefox browser. (Pages may be out of order for a short time.)
Security		
	Media security	Supports web- or SDK-based media stream encryption; supports a maximum of two channels of encrypted media streams; media stream encryption and full intelligence, target recognition, or image upload through SFTP/FTP cannot be enabled at the same time; after

Data security		the intelligent analysis function is enabled, only one-channel stream encryption is supported; supports encrypted storage of data in SD cards. By default, RTSP uses MD5 digest authentication.
	Video digital watermark	Supported
	Image digital watermark	Supported
Service security	User rights	Three user roles: administrator, advanced operator, and common operator
	Security mode	User name and password authentication, 802.1X authentication, and HTTPS digital certificate
	Secure boot	Supported
	System intrusion detection	Promiscuous network adapter detection; Sensitive system file detection; Unauthorized super account detection; Botnet detection; Rootkit detection; Trusted program detection; Privilege escalation detection

Port	
Storage port	One microSD card slot that supports microSDHC/microSDXC (maximum memory card capacity: 256 GB)
Alarm port	2 input port and 1 output port
Network port	One RJ45 10M/100M adaptive Ethernet port
Communication serial port	RS-485 port
Audio port	Supported (one-channel LINE IN and one-channel built-in microphone)/Supported (one-channel LINE OUT)

General Specifications	
Power type	DC12V, PoE (IEEE 802.3af)
Power consumption	Maximum: 10W, typical: 3.5W
Operating temperature	-30°C to 55°C
Storage temperature	-40°C to 70°C
Operating humidity	5% to 95% (non-condensing)
Surge protection	4kV
IP rating	IP67
Equipment Anti Corrosion	Class C
IK rating	IK10
Weight	Net weight 0.8kg; Gross weight 1kg
Dimensions	Device dimensions $\varphi 127\text{mm} \times 97\text{mm}$ ; Package dimensions $147\text{mm} \times 147\text{mm} \times 112\text{mm}$
Language	Simplified Chinese, English, French, Spanish, Portuguese (Europe), Portuguese (Brazil), Thai, Italian, and Turkish

## Dimensions

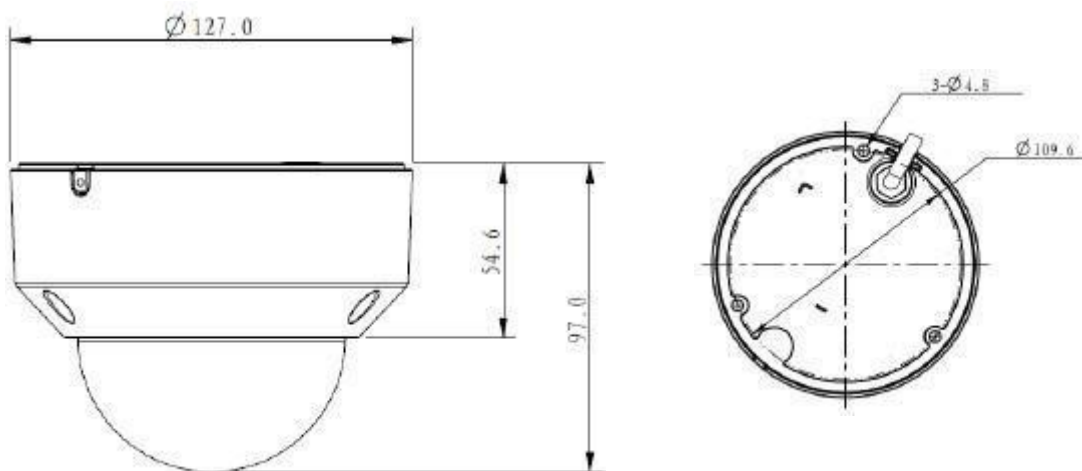

## Recommended Accessories



**ACC3311**

Wall-mount bracket  
for fixed dome  
cameras



**ACC3321**

Pendant-mount bracket  
for fixed dome cameras

## HOLLOWITS Contact

Address : 1 HARBOURFRONT AVENUE, #14-08, KEPPEL BAY TOWER, SINGAPORE 098632

Web: [www.hollowits.com](http://www.hollowits.com)

Copyright 2024. All rights reserved © HOLLOWITS TECHNOLOGIES PTE. LTD. No part of this document may be reproduced or transmitted in any form or by any means without prior written consent of HOLLOWITS TECHNOLOGIES PTE. LTD.

## General Disclaimer

The information in this document may contain predictive statements including, without limitation, statements regarding the future financial and operating results, future product portfolio, new technology, etc. There are a number of factors that could cause actual results and developments to differ materially from those expressed or implied in the predictive statements. Therefore, such information is provided for reference purposes only and constitutes neither an offer nor an acceptance. HOLLOWITS may change the information at any time without notice.



## Product selector

Scan the QR code on the right to view and compare specifications of HOLLOWITS products and select the best camera for you.